

OUTSTANDING

- Fence has a restrained, elegant industrial design
- Fence has a robust and deterrent appearance
- Rapid and simple erection
- Non-removable security screw system
- Unique and versatile post/frame fastening system

Application places



10
YEARS OF
GUARANTEE

Assembly

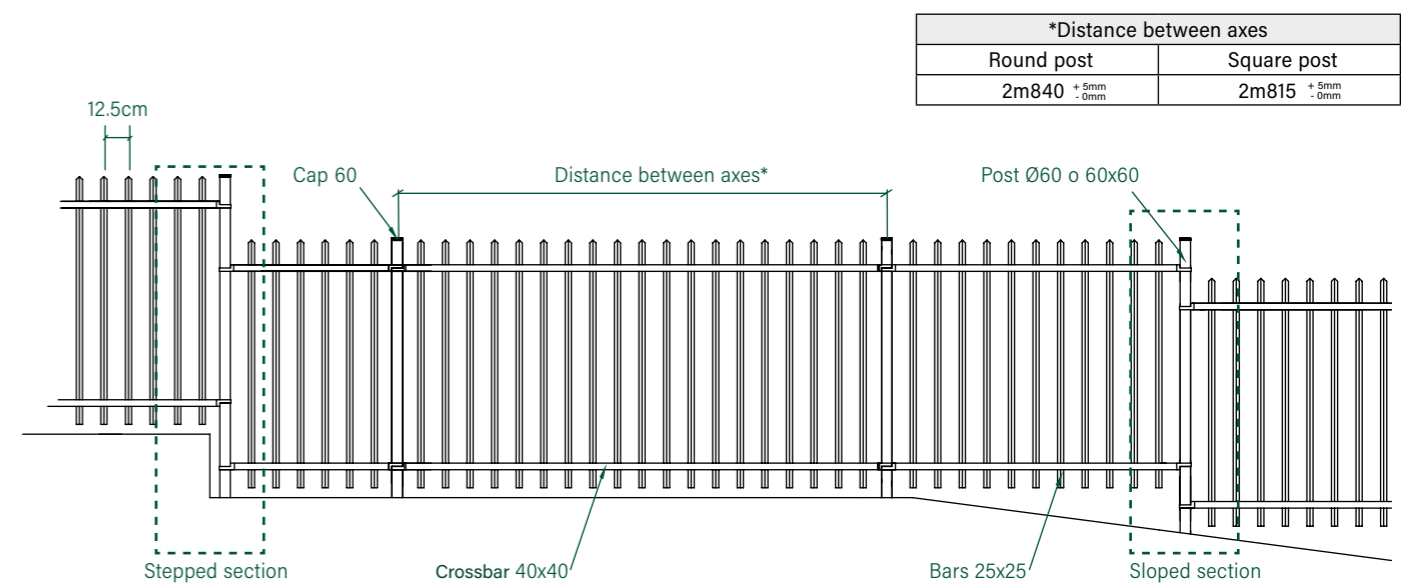

- The fastening between post and frame is made using metal straps manufactured from sheets 1.5 mm thick that give it a robust aesthetic and are discreet at the same time.
- Non-removable safety bolt system that offers a perfect technical solution with a high level of aesthetics.
- The strap model alone can provide changes in direction at different angles, slopes and stepped sections without the need for welds.
- On the stepped section and the sloping section, the longest post (normal length and step/drop) is placed on the lower part and fixed to the frames of both upper and lower sections.

Technical features

POST AND ACCESSORIES

- 60x2mm or 60x3mm steel-plated posts, depending on height
- Polypropylene cap will not degrade in harsh weather

PANEL

- Panel made of 40x40x1.5mm horizontal sections and 25x25mm square-shaped bars, thickness 1.5mm (vertical)
- Rapid assembly without welding

Detail of round post

Profile Ø60x2mm
Profile weight: 2.86Kg/ml
Galvanised sheet Z-275
I/V= 5.11cm³

Profile Ø60x3mm
Profile weight: 4.22Kg/ml
Galvanised sheet Z-275
I/V= 7.29cm³

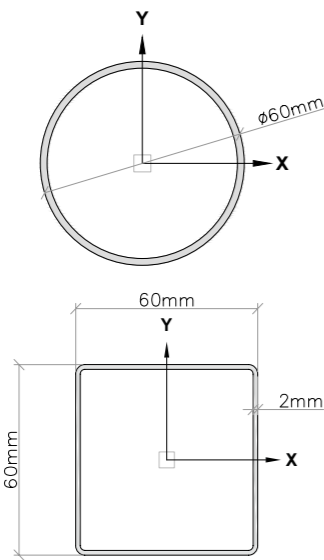

Detail of panel

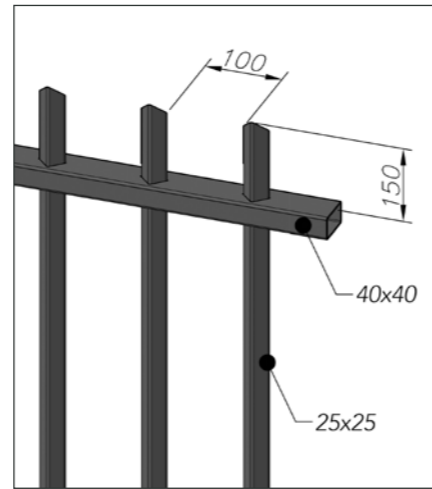

TYPE	PANEL		POST					
			ROUNDED POST		SQUARED POST		LENGTH	
	LENGTH	TYPE	TYPE (mm)	DISTANCE BETWEEN POST AXES	TYPE (mm)	DISTANCE BETWEEN POST AXES	CEMENTED	ON PLATE
1m00	2m750	1m00	Ø60x2	2m840 ^{+5mm} _{-0mm}	60x60x2	2m815 ^{+5mm} _{-0mm}	1m30	1m05
1m20		1m50					1m25	
1m50		1m90					1m55	
1m80		2m15					1m85	
2m00		2m35					2m05	

NOTE: For sections with more than 10 frames, it is advisable to readjust the interaxes so as not to accumulate errors in the measurement.

Finishes



Round post

The connection between the post and the frame is made with 1.5mm thick sheet metal clamps, which offer a robust but discreet appearance.

ROUND POST CONNECTION SYSTEM APPLICATION	
APPLICATION	Ø60mm round posts
MATERIAL	Metal clamps made of 1.5mm thick galvanized sheet metal.
FINISHING	The clamps are plasticized with Rivisa's Protecline coating system and in the same color as the gate.
COMPOSITION	Clamp + Bolts and screws

UNITS PER POST	
INTERMEDIATE POSTS / ANGLE	4 pcs. post
EXTREME POSTS	2 pcs. post

INTERMEDIATE POST

Install the attachment to make a special-width panel and bolt the assembly to the post attachment.

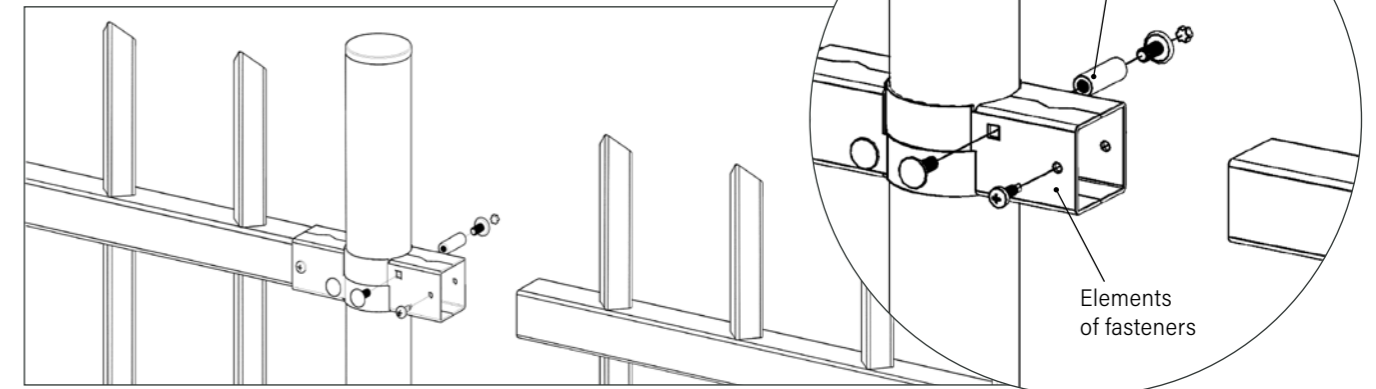

Square post

The connection between post and frame is made with high-strength plastic bushings.

SQUARE POST CONNECTION SYSTEM	
APPLICATION	60x60mm square posts
MATERIAL	Sleeves manufactured in polypropylene
FINISHING	Polypropylene black colour
COMPOSITION	Bushing + M8 Screws + M8 Nut

INTERMEDIATE POSTS	
INTERMEDIATE POSTS	4 pcs. bushing + 2 pcs. screws
ANGLE POST	4 pcs. bushing + 4 pcs. screws
EXTREME POSTS	2 pcs. bushing + 2 pcs. screws

INTERMEDIATE POST

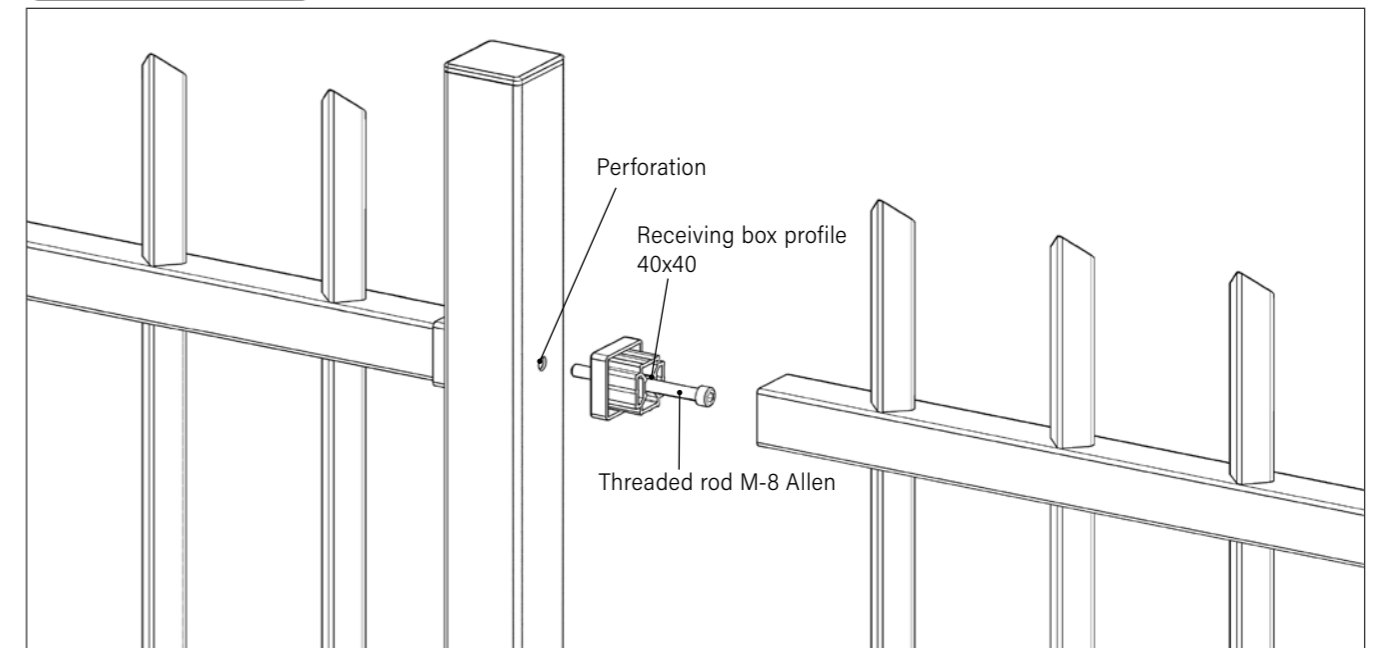

Anchoring systems

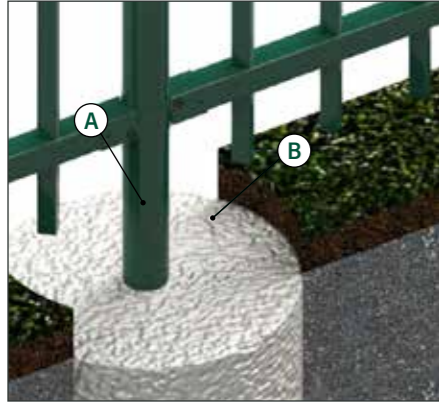

FOUNDATION
Post installation with concrete footings.
A. Post
B. Foundation

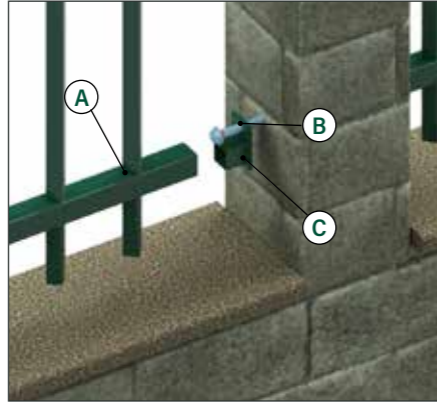

WIDTHR
Option of installing the fence with a side plate.
A. Ultra fence frame
B. Wall plate
C. Anchor

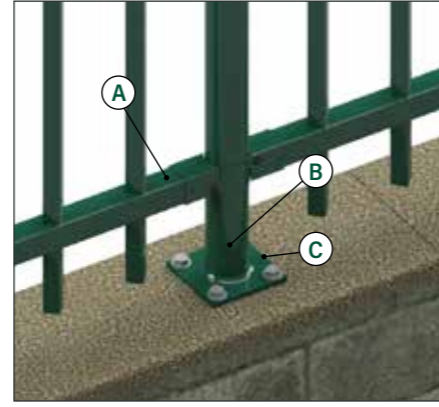

BASE PLATE
Option of incorporating base plate to install the posts on concrete walls and gates with a height > 2m. Dimensions of the plate 120x120x8mm.
A. Post
B. Wall plate
C. Anchor

Anticorrosion coating

All the materials of system are hot dip galvanised and plastic coated with **Rivisa® Protecline** anticorrosion coating system.

- Minimum thickness: 100 microns
- Option of applying the **Rivisa® Protecline Plus** plastic coating, which prolongs the useful life of the materials
- Option of applying the **Rivisa® Protecline Plus triple** plastic coating, which prolongs the useful life of the materials
- Available in several colours from the Rivisa RAL chart. Colours:



protecline

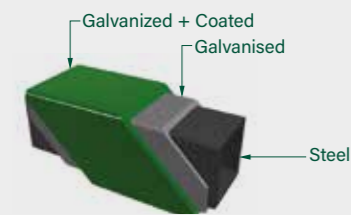

protecline PLUS

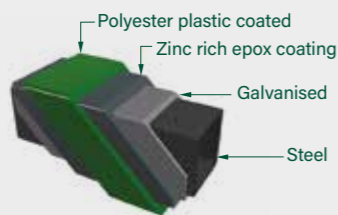

protecline TRIPLE

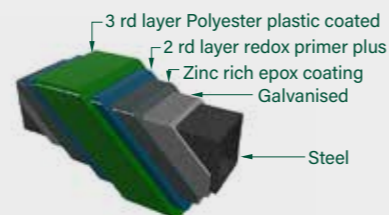

Assembly manual

Preparing the ground

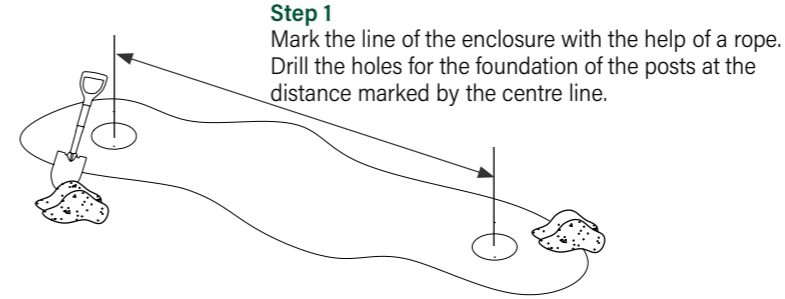

Step 1
Mark the line of the enclosure with the help of a rope. Drill the holes for the foundation of the posts at the distance marked by the centre line.

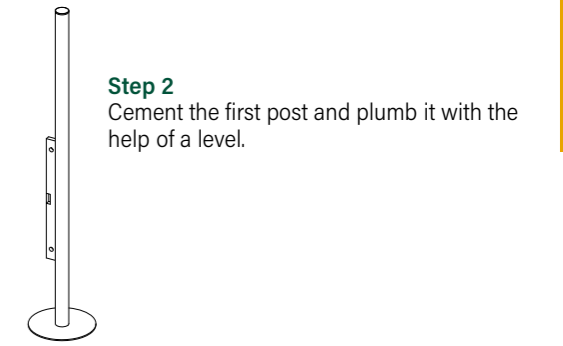

Step 2
Cement the first post and plumb it with the help of a level.

Post and clamp assembly

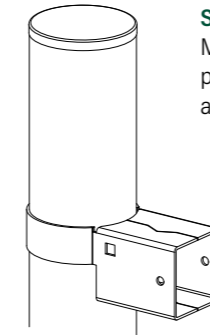

Step 3
Mount the metal clamp on the post (4 pcs. per intermediate post and 2 pcs. per end post).

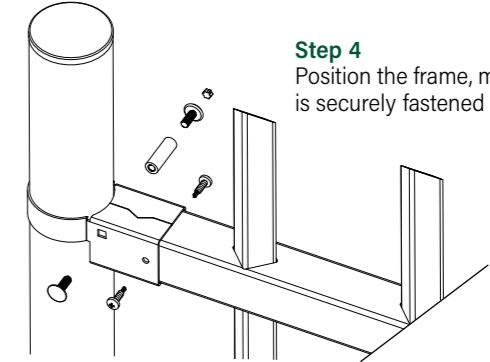

Step 4
Position the frame, making sure that it is securely fastened inside the clamps

Frame and end section assembly

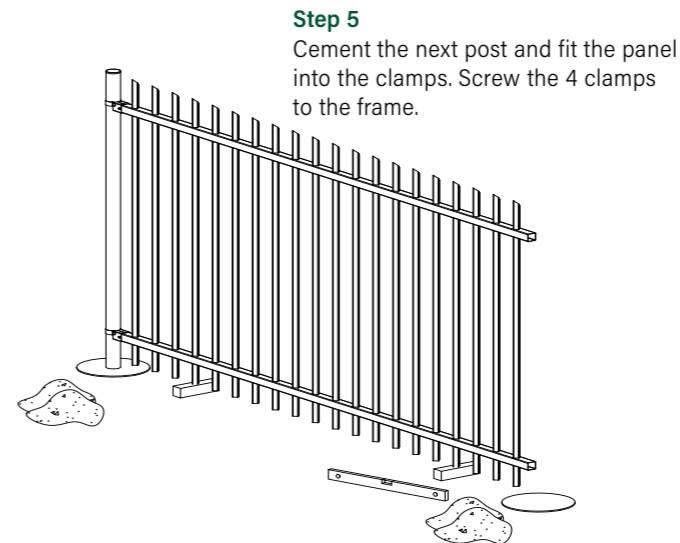

Step 5
Cement the next post and fit the panel into the clamps. Screw the 4 clamps to the frame.

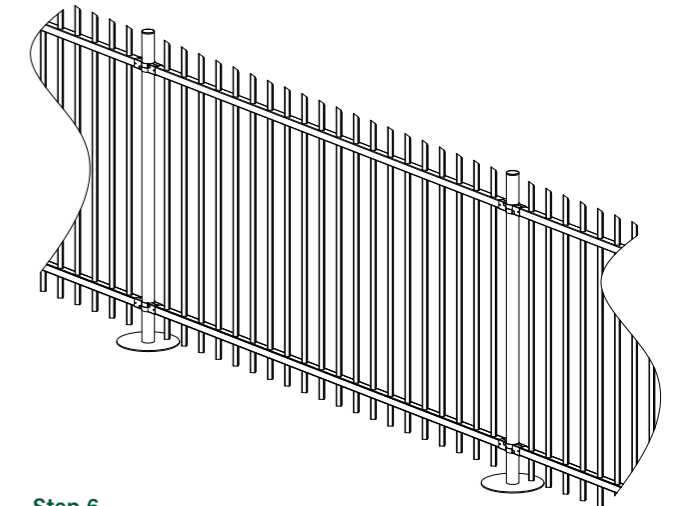

Step 6
Repeat the operation as many times as necessary. If base plate anchoring has been used instead of foundation anchoring, screw the base and insert the first post. Hook the panel and insert the next post.



ULTRA