

CANTILEVER SLIDING GATE



CANTILEVER SLIDING GATE

10
YEARS OF
GUARANTEE

OUTSTANDING

- Opening and closing system without rail
- Ease of operation
- Complete system
- Lifetime anti-corrosion coating for superb
- Gates approved according to CE

Technical features

THE CANTILEVER GATE IS IDEAL FOR:

- Areas where a tall space is available for the opening of the gate (about 2 times the span of the gate).
- Areas where the ground that regularly covered with snow.
- Places where there is constant traffic of vehicles and heavy trucks, such as quarries, factories, warehouses, airports and military installations.

TECHNICAL DETAILS:

- Gates with a total access available from 5 to 9 metres for only one leaf.
- Lower beam with a profile of 120x120x4mm
- Frame with a profile of 100x50x2mm
- Interior filling of the leaf 35x35x1.5mm

The Cantilever Gates are made with the following elements:

DESCRIPTION	HEIGHT	LOWER PROFILE (mm)	PANEL PROFILE (mm)	FILLING	END POST
Gate 5m	2m	120x120x3	100x50x2	Vertical bars 25x25mm	100x50x2
Gate 6m		120x120x3			
Gate 7m		200x100x4			
Gate 8m		200x100x4			
Gate 9m		200x150x4			

Application places

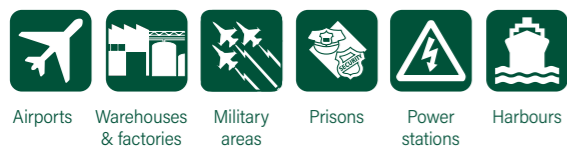

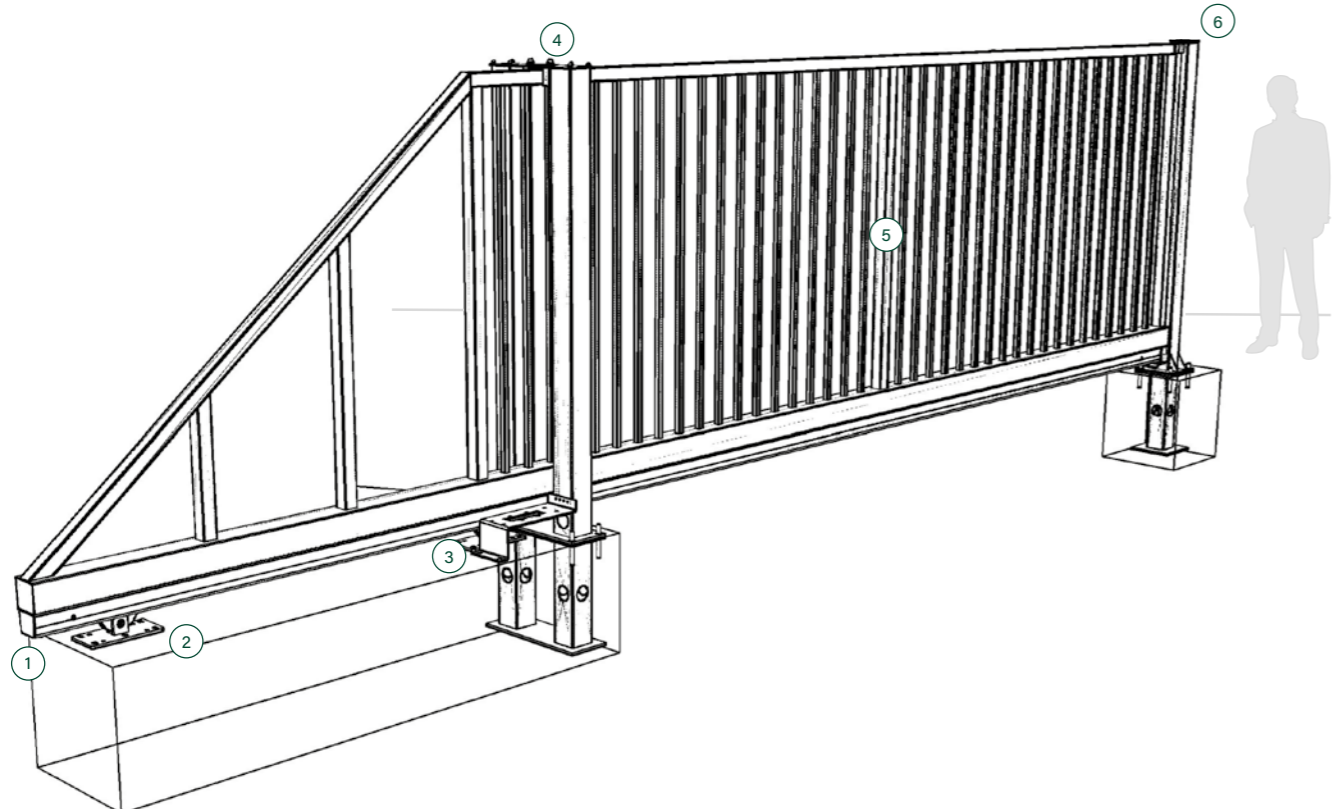

1. LOWER GUIDE: guidance system for the cantilever carriages to ensure that the gate slides perfectly.

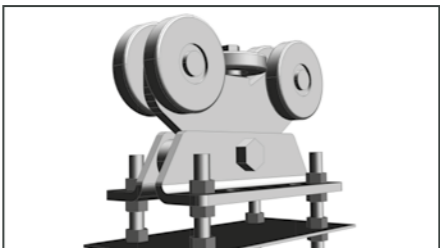

2. GUIDE CARRIAGE: 2 sets of cantilever rollers inserted in the lower profile.

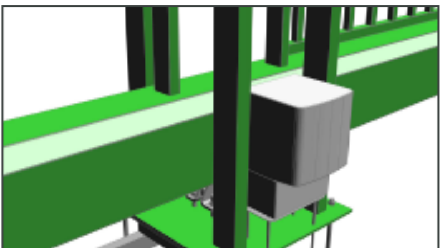

3. Optional electrical functioning for applications of industrial use and zones where a control of the accesses is needed. The electrical functioning system of the cantilever gates consists of high-resistance motor reducing gears.

4. BRIDGE GUIDE: nylon wheels fitted with high strength and base plate for a perfect foundation.

5. Leaf of cantilever type and variable measures, made with profiles of great inflexibility and oversized plinth.

6. CLOSING COLUMN: Structure of double final column of closing and safety gate stopper.

Marking CE of swing doors

DOORS WITH MARKING CE

Rivisa® complies with the standard: **EN-13241-1:2003** which defines the safety and performance requirements for swing doors when installed in areas accessible to people. Rivisa® standard doors have successfully passed the **"DECLARATION OF CONFORMITY TEST"** to obtain the certificate.

Model

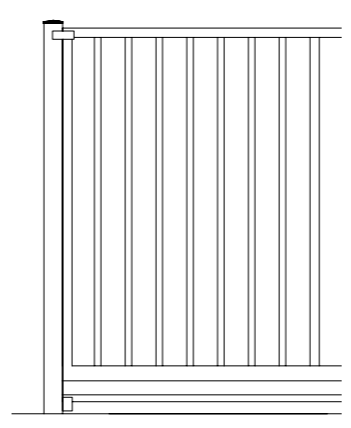

CALITAX
Calitax sliding gate filled with vertical profiles measuring 35x35x1.5mm, blending with all models of fences.

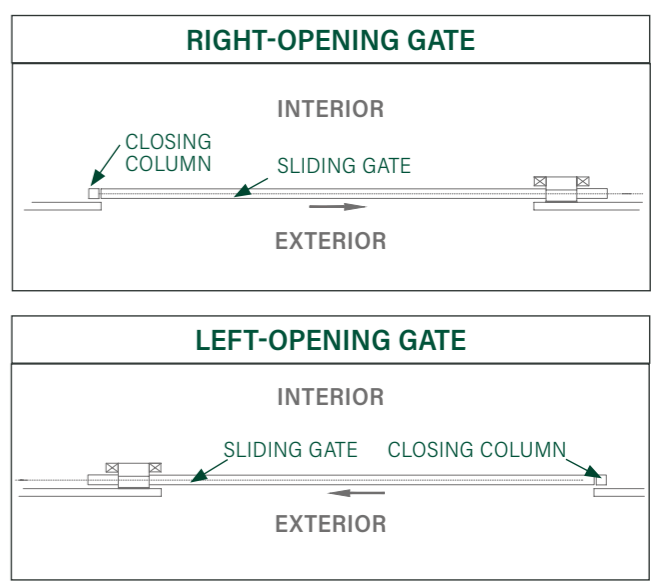

- Gate leaf:**
- Made of rectangular profiles welded to a lower beam of great strength.
 - In the case of manual opening, the gate lock is fitted.
 - Safety gate stopper for an optimal closing of the gate.

- Bridge guide and closing column:**
- The bridge guide and closing column are installed with a base plate.
 - The bridge guide and the closing column are provided with a nylon roller for perfect adjustment of the opening and closing movement.

Anticorrosion coating

All the materials of the system are hot-dip galvanised and plastic-coated with the Rivisa® Protecline anticorrosion coating system.

- Minimum thickness: 100 microns
- Option of applying the Rivisa® Protecline Plus plastic coating, which prolongs the useful life of the materials
- Option of applying the Rivisa® Protecline Plus triple plastic coating, which prolongs the useful life of the materials
- Available in several colours from the Rivisa RAL chart. Colours:

